

TANNUS

Airless Tire

This brief User Manual contains important information. Please read carefully and store in a safe place.

This user manual is for Tannus Tires. It contains important safety, performance and technical information, which you should read before your first ride and keep for reference. You should also read the entire Owner's Manual because it has additional important general information and instructions which you should follow. If you do not have a copy of the Owner's Manual, you can download it at no cost at www.tannus.com

When reading this manual, you will note various important symbols and warnings, which are explained below:



WARNING

The combination of this symbol and word indicates a potentially hazardous situation which, if not avoided, could result in serious injury or death. Many of the Warnings say "you may lose control and fall." Because any fall can result in serious injury or even death, we do not always repeat the warning of possible injury or death.



TECH TIP

Tech Tips are useful tips and tricks regarding installation and use.

Intended Use

The Tannus Airless tire is intended for use on paved roads only. Replace the tire when the center tread is worn out.



Traction is reduced when riding on gravel or slippery road surfaces. Use caution when riding in low traction conditions.



The Tannus Airless tire has a structural weight limit of 165lbs (75Kg) per tire or 330lbs (150Kg) for a pair. This means the combined weight of the bicycle and the rider, including all accessories and equipment, may not exceed 330 lbs (150Kg)

Warranty

1 year manufactures warranty or 9000km (6000m) whichever comes first

General Notes About Assembly

This manual is not intended as a comprehensive use, service, repair or maintenance guide. Please see your Authorized Tanus Retailer for all service, repairs or maintenance.



Due to the different mounting method from regular bicycle tires, and the difficulty of installation, We recommend the installation of the Tannus Airless tire needs to be performed by an Authorized Tannus Retailer.



Please remove the tire and tube from the rim before you begin. Do not use rim tape between the rim and the tire. The Tannus tire has been designed to work together with the rim without rim tape.

General Notes About Maintenance

To get the most potential out of your tire it is recommended that you pre-ride a minimum of 100km.



Ensure the pins are the correct spec for the rim width, the tire is mounted correctly and spins straight, and the pins are fully inserted in the rim. Incorrect assembly can result in failure of the tire, which can result in serious injury or death.



Regularly inspect the tire for excessive wear and/or damage. If the center tread is worn out and/or the tire is damaged, see your Authorized Tannus Retailer for replacement. Do not skid the rear tire as it can result in flat spots, which can lead to tire imbalance and unsafe riding conditions.

For more information please visit tannus.com

Installation

TANNUS

1a. Identifying Correct Pin Size

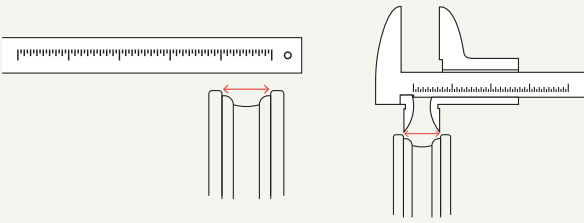

Before fitting your Tannus Tires, the correct pin size must be obtained. Generally, the size of the pin is +3.5mm wider to the measured rim width.

1b. Identifying Correct Pin Size

 If there are no calipers or ruler available, directly insert pins with a plier. Pins are inserted vertically, then twisted horizontally to fit the width of the rim. Please be cautious, as excessive force of pins of an incorrect size can damage the rim.

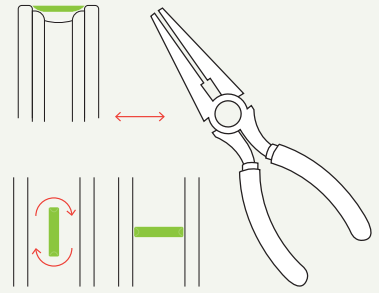

2a. Pin Insertion

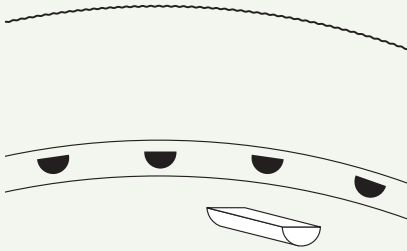

After choosing a suitable pin size, insert the pins into the pin-holes of the tire. When inserting the pins ensure that they are placed the correct way, with the flat surface facing up.

2b. Pin Insertion

Using the back of the tool provided push down onto the pin

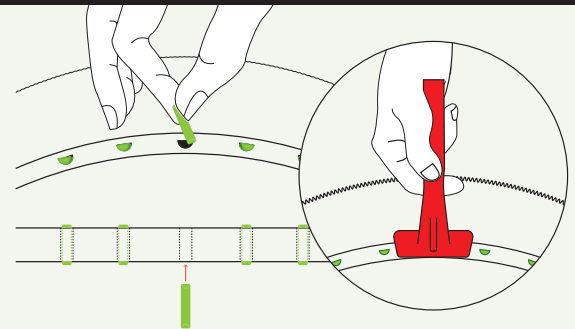

3. Tire Mounting

After inserting all the pins, mount the tire onto the rim. Using constant even pressure on both thumbs and then popping the final section over the rim. Thicker Tannus can be secured with a single pin or a cable tie and then leveraged on using the supplied tool like a tire lever, some assistance may be required on the final section.

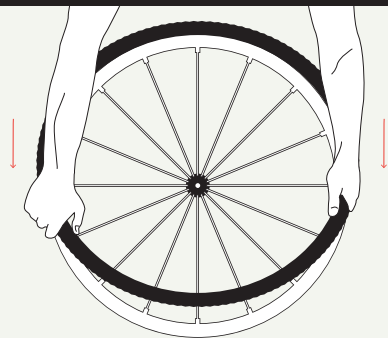

Make sure to stretch the tire before mounting for easier installation.

4a. Lock Pins into Place

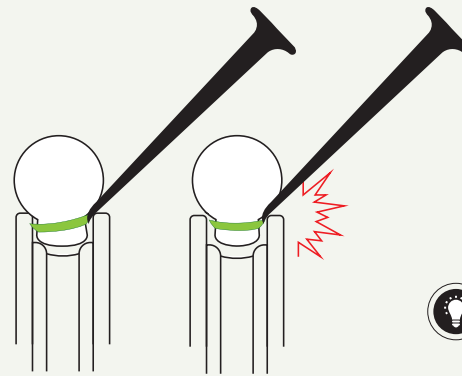

Place the tip of the tool at a seventy degree angle onto a pin and push deeply towards the tire. When the pin is inserted correctly a click can be heard.



Place wheel inbetween legs while locking pins into place

4b. Lock Pins into Place

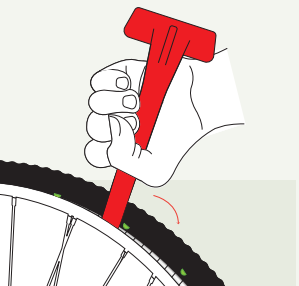

As you are locking the pins into place make sure to tuck in the tire lip into the rim as you go.



This refers to the space between each pin.

5. Inspect Installation

After locking all the pins inside the rim, inspect the tire both sides in detail. Pins that remain visible are have to be locked in correctly and require further attention.

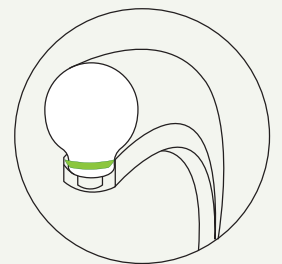

Installation Video

For step by step instructions please watch video here: <http://tiny.cc/tannus>

Please note all instructions and notices are subject to change and updates without notice.
Please visit tannus.com for further information
Feedback: info@tannus.com